

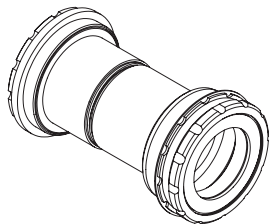

PF30A Road TO ROTOR 3D+ TWIST-FIT BB System

TRiPEAK Product NO.
EMA-PF30A3D-RO★TF12



Bearing Options

★ SB (Steel Bearing) / ★ CB (Ceramic Bearing)

● Bearing Size : 42 X 30 X 7mm (6806-2RS)

Replacement Bearing set

TRIPEAK item NO. SB : EMA-HP6806-2RS / CB : EMA-JC6806-2RS

Outer
Seal Cover

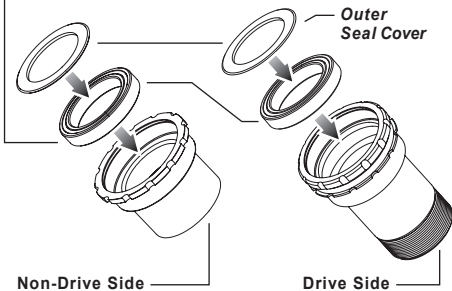

Step 1

PRESS IN

Non-DRIVE SIDE

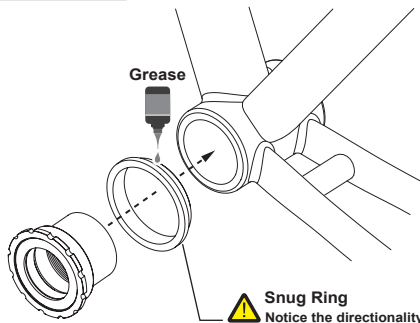

Step 2

TWIST-LOCK

DRIVE SIDE Cup set lock to 30Nm

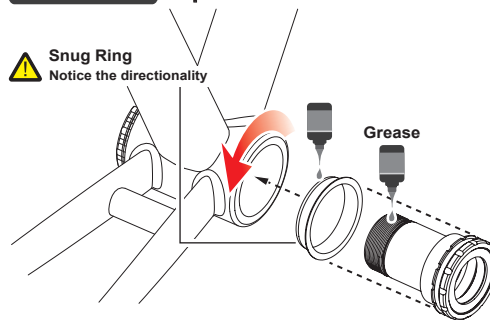

⚠ NOTICE

- To install TRIPEAK Bottom Bracket, we strongly recommend that you have a trained bicycle mechanic at your local bike shop.
- Do not alter this product in any way as it can cause unseen damage. Any modifications to this product will void the warranty.
- Make sure with the cranks are firmly attached to the bottom bracket. Improperly attached cranks can become detached from the BB set.
- When cleaning the bottom bracket set, only use mild soap and water. Never spray with high-pressure water. It will cause BB cup internal water ingress and influencing the bearing rolling lifetime.
- If you have any questions or concerns about this product Please feel free to contact us. E-mail: info@tripeakbearing.com

Snug-Ring PA+GF Mold & CNC Finished

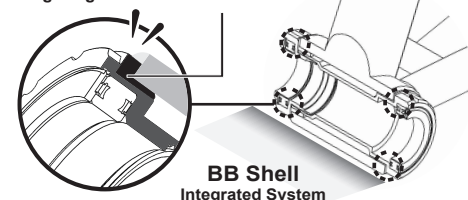

Installed-Width

